

# Simplify



## F6 Biometric Fingerprint Terminal



### Features:

- Slim and elegant design
- Reliable, durable and highly accurate ZK optical sensor with version 10 fingerprint algorithm
- Less than 1 second user recognition
- Built-in 125kHz RFID proximity reader
- Reads finger and/or RFID cards
- Built-in Wiegand output port for connection to third party access control panels
- Built-in SD card reader for manual data transfer
- Audio – Visual indication for acceptance and rejection of valid/ invalid fingers
- Tamper switch

**ZKTeco**<sup>®</sup>

**South Africa**

ZKACCESS<sup>®</sup>

ZKSoftware<sup>®</sup>

ZKBiOlock

ZKiVision

ZKAFIS

All design and specification declared are subject to change without notice In advance Copyright © 2012 ZKTeco Inc. All rights reserved

## Standalone Configuration:

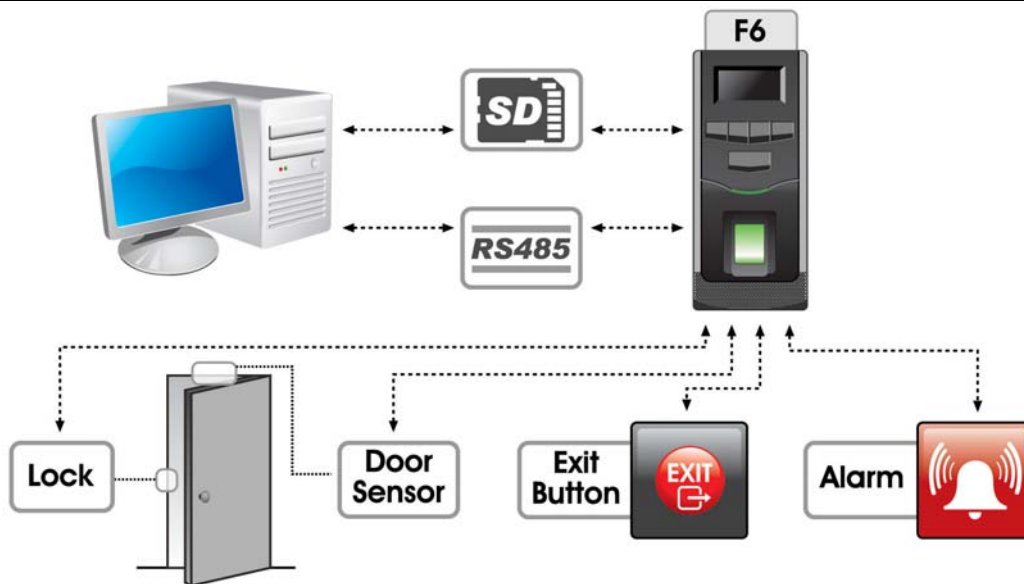

## 3rd Party Controller Configuration:

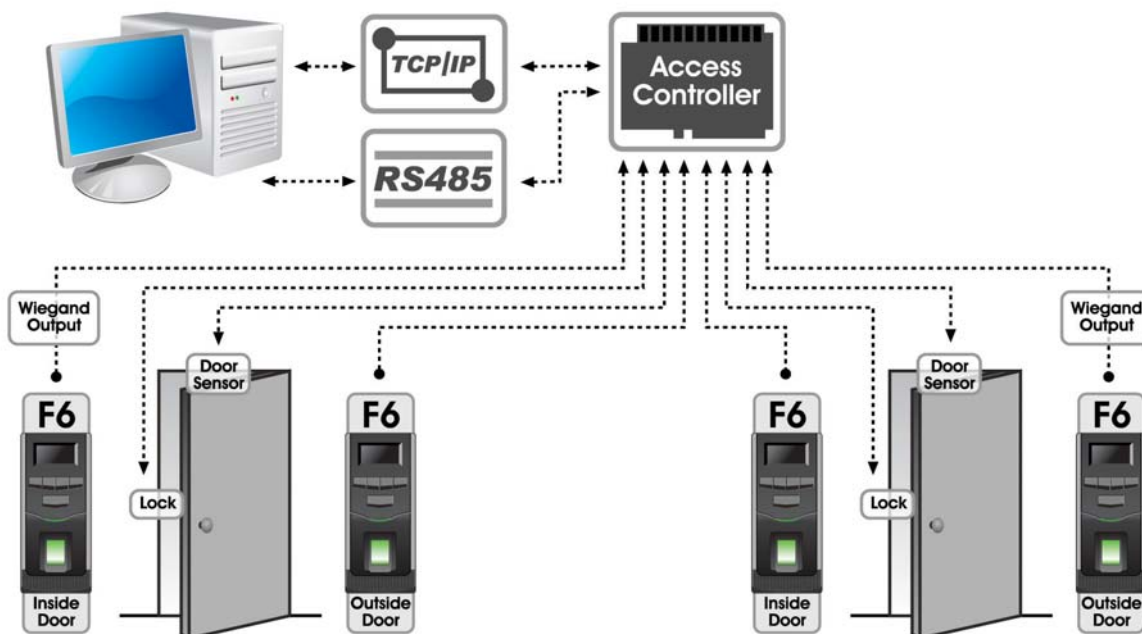

## Specifications:

Fingerprint Capacity:	500 templates
Transaction Capacity:	30 000 transactions
Sensor:	ZK Optical Sensor
Algorithm Version:	ZK Finger V10.0
Display:	Black and white OLED Screen
Communications:	RS485, SD Card
Built-in Card Reader:	125kHz RFID proximity reader
Wiegand Ports:	Output any bits
Access Control interfaces:	3rd party electric lock, door sensor, exit button, open door alarm
Dimensions:	255x68x38 mm
Power Supply:	12VDC, 3A

**ZKTeco**®

Unit 5, Wellness Corporate Park,  
Hartbeespoort  
Tel: +27(0)12 259 1047  
Email: info@zkteco.co.za  
www.zkteco.co.za

CE FC RoHS

South Africa

ZKAccess

ZKSoftware

ZKBiLock

ZKiVision

ZKAFIS